

Jump Start Guide

USB TYPE A TO USB TYPE A HUB
FIBER OPTIC EXTENSION CABLE

Bullet Train

featuring  CLEERLINE SSF™

The AC-BTSSSF-USB3-HUB is a 4 Port, Active Optical, USB 3.1 Gen 1 Extension Hub capable of max data rate up to 5Gbps. Equipped with four USB 3.1 Gen 1 Type A ports with legacy USB 1.X and 2.0 support, this USB hub can host many devices from the basic keyboard and mouse combinations to High-End webcams and Solid-State Drives simultaneously.

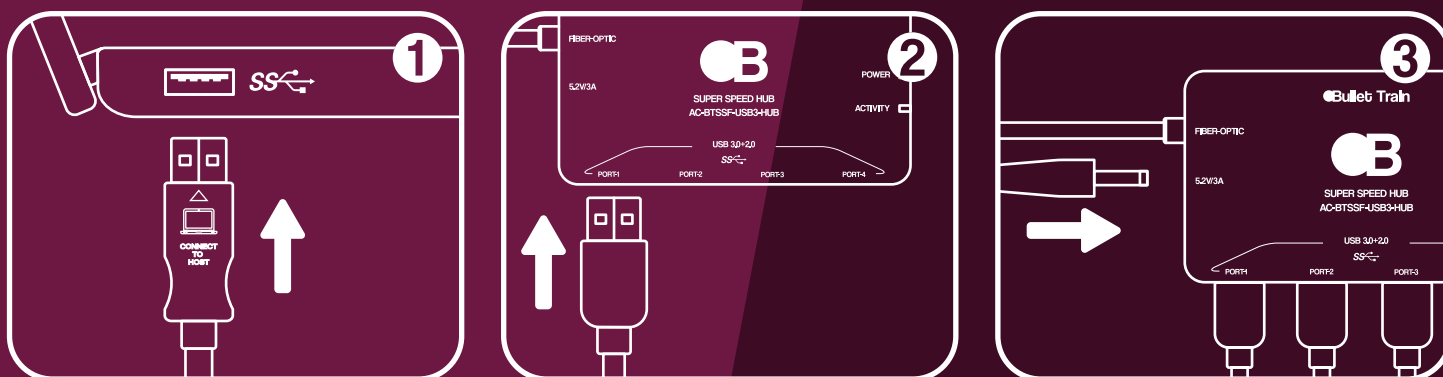

1. Connect the Male USB 3.1 Gen 1 Type A Host Head into a USB Type A Port on the desired Host Device (Laptop, PC, Conference System). For best results, a minimum of a USB 3.0 Superspeed Port should be used.
2. Connect desired USB devices into the Female USB 3.1 Gen 1 ports located on the Hub.
3. Connect Power Supply (Recommended)
 - a. Without PSU - Unit will operate with USB 1.X/2.0 only, up to 480Mbps
 - b. With PSU - Unit will fully operate with USB 1.X/2.0/3.1 Gen1 up to 5Gbps

Troubleshooting

- USB Device Not Found - Ensure the correct driver is installed for the device
- My USB to Video device isn't working - The AC-BTSSSF-USB3-HUB does not support USB Alt modes such as HDMI Alt Mode or DP Alt Mode
- Webcam not showing when using Multiple Cameras - USB 3.X camera resolutions require a high amount of bandwidth and will quickly hit the max data rate of 5Gbps. 1x 4K30 or 2x 1080p60 Camera(s) is the recommended limitation with USB 3.X cameras
- USB 3.X device not working - Ensure a USB 3.X Host port is used. Ensure PSU connection and functionality.